

Dimensions: mm (in.)

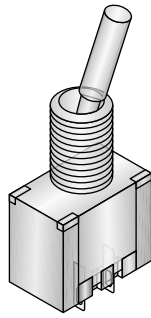

POS.1	POS.2
ON	OFF
2-3	OPEN

Switch Function

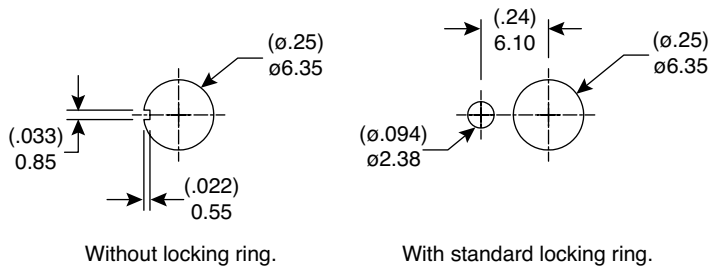
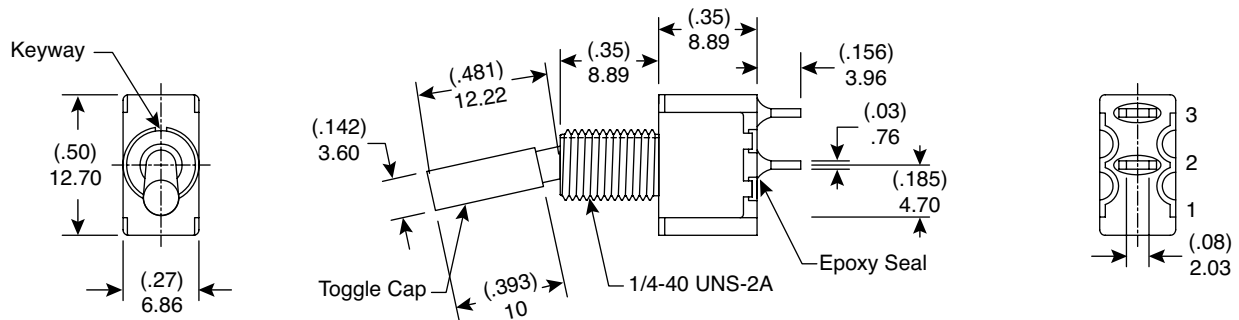

Panel Mounting

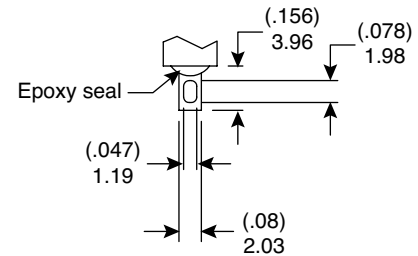

Solder Lug

Mechanical Specifications:

- Mechanical Life: 40,000 make-and-break cycles
- Operating Temperature: -30°C to 85°C

Electrical Specifications:

- Rating: 2Amps / 250VAC, 5Amps / 120 VAC or 28 VDC
- Contact Resistance: 10mΩ max. initial @ 2-4VDC 100mA
- Insulation Resistance: 1,000MΩ min.
- Dielectric Strength: 1,000 V RMS@sea level

Materials:

- Case: Diallyl phthalate (DAP)
- Actuator: Brass, chrome plated
- Bushing: Brass, nickel plated
- Housing: Stainless Steel
- Terminal/Contact: Silver or gold plated

Note:

- RoHS compliant by exemption

Mouser Stock No.	Type	Circuit	Cap Color
108-0038-EVX	SPST	Off-On	Black
108-0040-EVX	SPST	Off-On	Red

Miniature Toggle Switches
108-0038-EVX, 108-0040-EVX

